



M O N E O
P H A R M A G R O U P

Moneo Pharma Group Professional solutions for Healthcare Market

Moneo Pharma Group Sp. z o.o.

01-015 Warszawa, ul. Skwer Ks. Kard. Stefana Wyszyńskiego 5 lok. 25

tel/fax: 22 621 67 80, e-mail: biuro@moneopharma.pl

Our Activities:

- Pharmaceuticals, Super Generics, Insulin, Anticancer,
- Structure of Hospital,
- Hospital beds & furniture's,
- Delivery Beds, Gina Beds, Dialyze Chair, Wheel Chair,
- Syringe & IV Pumps,
- Modular Monitors,
- Dental Units, Hand Pieces, Accessories & Supplies,
- Anesthesia Machines, Standard + Xenon,
- Servo ventilators, Monitors,
- Computers, LCD, LED, Tablet + Laptop, All in one PC,
- Bed Head Units,
- Infant Transport + ICU Incubators,
- Surgical Instruments,
- Hospital supplies & Disposables,
- Turn key projects, Hospitals + Pharma plants,
- Mobile Hospitals,
- Ambulances,
- **Medical & Sport Recruitment,**





M O N E O
P H A R M A G R O U P

Moneo Pharma Group strategical Partner

Menaret Int. Est. Medpharma Division



 HOSPITAL FURNITURE	 ANESTHESIA + VENTILATORS	 DENTAL UNITS + HAND PIECES	 MEDICAL EQUIPMENTS
 SYRINGE + INFUSION DOSE PUMPS	 MODULAR MONITORING	 DELIVERY + GINA BEDS	 OPERATION TABLES
 OPT + LED LIGHT	 MINI PC, TABLET PC, NOTEBOOKS, ALL IN ONE PC & LCD	 MEDICAL, PHARMA, SPORT STAFF	 BED HEAD UNITS
 INFANT INCUBATORS	 COMPLETE SURGICAL INSTRUMENTS	 X - RAY, CT, MRI SERVICE	 HOSPITAL & MEDICAL DISPOSABLES
 HAEMOSTATIC PRODUCTS	 HEMODIALYZA SETS	 HOSPITAL PHARMACEUTICAL TURN KEY PROJECTS	 PHARMACEUTICAL TURN KEY PROJECTS
 PHARMACEUTICAL PRODUCTS	 PHARMACEUTICAL & FOOD SUPPLEMENTS	 PHARMACEUTICAL & FOOD SUPPLEMENTS	 PHARMACEUTICAL & FOOD SUPPLEMENTS
 X-RAY FILAM	 LABORATORY TESTING	 WOUND TREATMENT	

- The purpose of MPG's activity is comprehensive fulfilling of healthcare market needs and fostering of strong business relationship with our partners.

- Our actions are characterised by reliability and safety. Services offered by MPG meet top professional standards and are always performed in a timely fashion.



M O N E O
PHARMA GROUP

Our customer in General:

Markets of Europe, USA and Middle East countries.

- **Governmental Sector (MOH):**
MOH hospitals, & Gulf countries
council unified tender (SGH)
- **Institutional Hospital Sector:**
(semi governmental) i.e. Military, educational.
- **Private Sector:**
Private companies, drug importers, hospitals,
polyclinics & pharmacies.

Customer Satisfaction

Moneo Pharma Group offers to you the best top Medical & Pharmaceutical Companies Products & Manufactures from Europe, Czech, Slovak, Poland Republic.

Moneo Pharma Group offers to you their services to provide you with all it is agencies & products with top quality, best price possible, reliable partnership,

Moneo Pharma Group has the trained staff to deal with sensitive issues to guarantee the quality & effective of the business.

WE are ready to serve you the best.



Moneo Pharma Group offers for It's Partners:

- Large experience in the Healthcare field.
- Top & Strategical partners.
- Strategically positioned branches.
- Excellent reputation & connections in the Europe, USA, Saudi & Middle East market.
- Professional business oriented team, focused on the results.



Moneo & Minaret Co-operation Project.

STRUCTURE OF HOSPITAL

STRUCTURE OF HOSPITAL

Example

Private Sector Hospital Project

200 Bed Hospital

Turnkey Project

For Planning, Design, Equipments

Procurement and Construction

STRUCTURE OF HOSPITAL

Example

We implement the project in accordance to international standards and latest technology in this field, taking into consideration the followings:

- Provide efficient design,
- Build a high quality project,
- Provide the project in time,
- Provide the project on budget,
- Train end user (Doctors, Nurses, Engineers),

STRUCTURE OF HOSPITAL

Example

We have a comprehensive design that features components to include but not limited to:

- Modern architect,
- Medical grade materials all over the building for hygiene and safety concepts,
- Durable design specifications,
- All brand new & latest technology material specifications,
- All heavy duty material and long life equipments & systems,

STRUCTURE OF HOSPITAL

Example

- Low running cost hospital design in terms of design, materials and manpower,
- Expandable design in the future to include additional beds, Clinics, new diagnostic departments,
- Latest air conditioning & medical gases systems,
- Fast evacuation concept with large corridors & appropriate exits,
- Power supply system, mains, critical power & UPS power,

STRUCTURE OF HOSPITAL

Example

Outpatient clinics include:

- *Surgery.*
- *Internal medicine.*
- *Cardiac unit.*
- *Rehabilitation.*
- *Rheumatology.*
- *Orthopedic.*
- *Neurology with EMG.*
- *Chest clinic with spirometry.*
- *Gynaecology.*
- *Pediatric.*
- *Sensitivity, Urticaria center.*
- *Digestion disease center.*
- *Gland system disease.*
- *Nerve – spiritual disease center.*
- *ENT disease center.*

STRUCTURE OF HOSPITAL

Example

In – Patients:

- 200 beds, with bed side cabinets & over bed table,
- Bed head unit to include, O2, Vacuum, Compressed air,

Room light, Reading light, telephone socket, nurse call,
Electric sockets.

- ICU, 8 beds with bed side monitors & central station,
- CCU, 8 beds with bed side monitors & central station,
- Recovery room, 8 beds with monitors & central station,
- NICU, 10 baby incubators & all other related equipments,

STRUCTURE OF HOSPITAL

Example

Theatre, 8 rooms, complete with all necessary equipments as the followings:

- General surgery,
- Orthopedic,
- Neurosurgery,
- ENT, surgery,
- Ophthalmic surgery,
- Delivery room,
- Cardiac surgery,
- Dermatology,

STRUCTURE OF HOSPITAL

Example

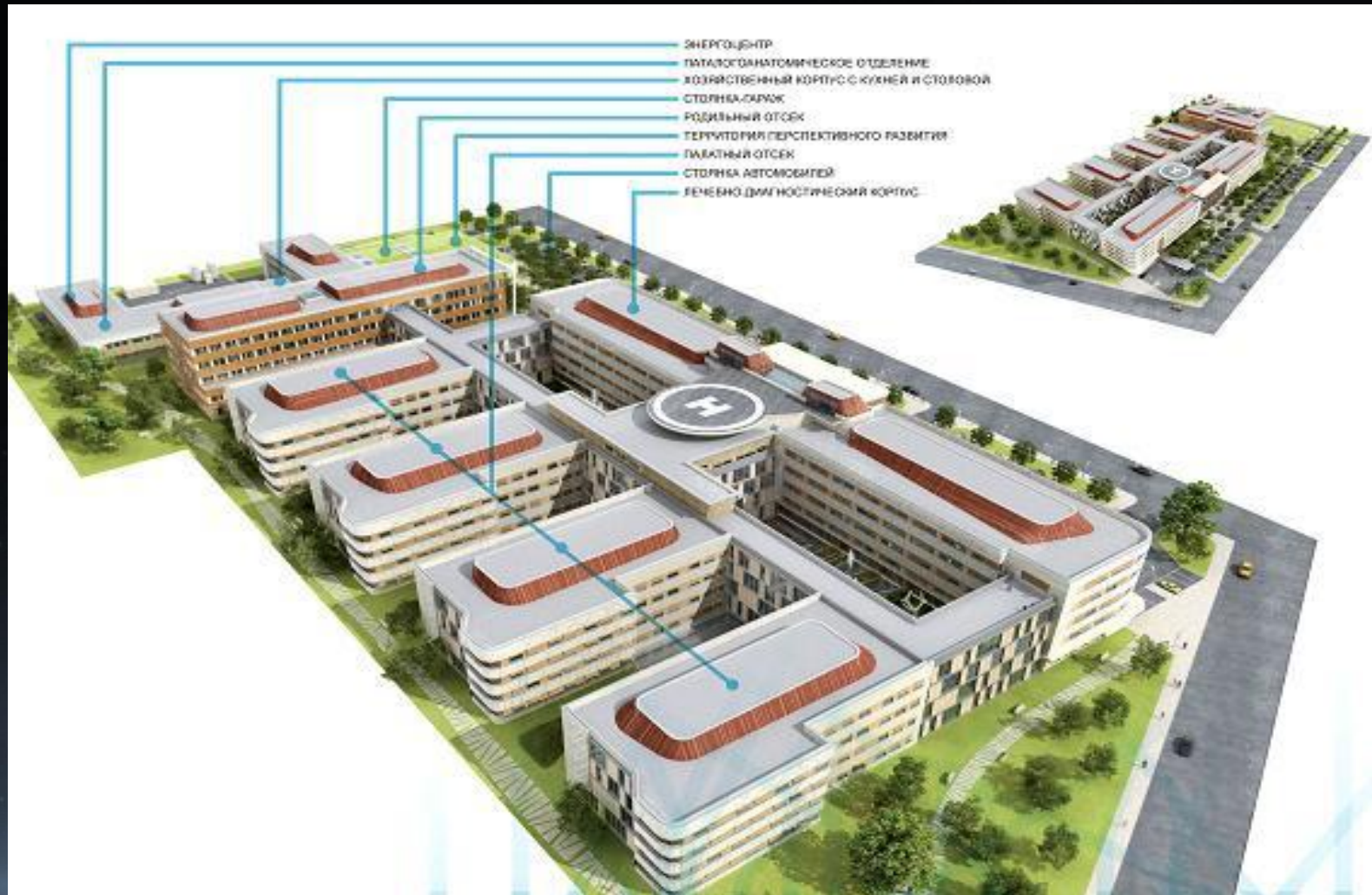

STRUCTURE OF HOSPITAL

Example



STRUCTURE OF HOSPITAL

Example



MONEO PHARMA GROUP

MEDICAL EQUIPEMENT PORTFOLIO

Medical Equipment

- Hospital beds & furniture's.
- Delivery Beds, Gina Beds, Dialyze Chair, Wheel Chair.
- Syringe & IV Pumps.
- Modular Monitors.
- Dental Units, Hand Pieces, Accessories & Supplies.
- Anesthesia Machines, Standard + Xenon.
- Servo ventilators, Monitors.
- Computers, LCD, LED, Tablet + Laptop, All in one PC.
- Bed Head Units.
- Suction Unit, Suction Pump.
- Infant Transport + ICU Incubators.
- Surgical Instruments.
- Hospital supplies & Disposables.
- Turn key projects, Hospitals + Pharma plants.
- Mobile Hospitals.
- Ambulances.
- Medical & Sport Recruitment.



M O N E O
P H A R M A G R O U P

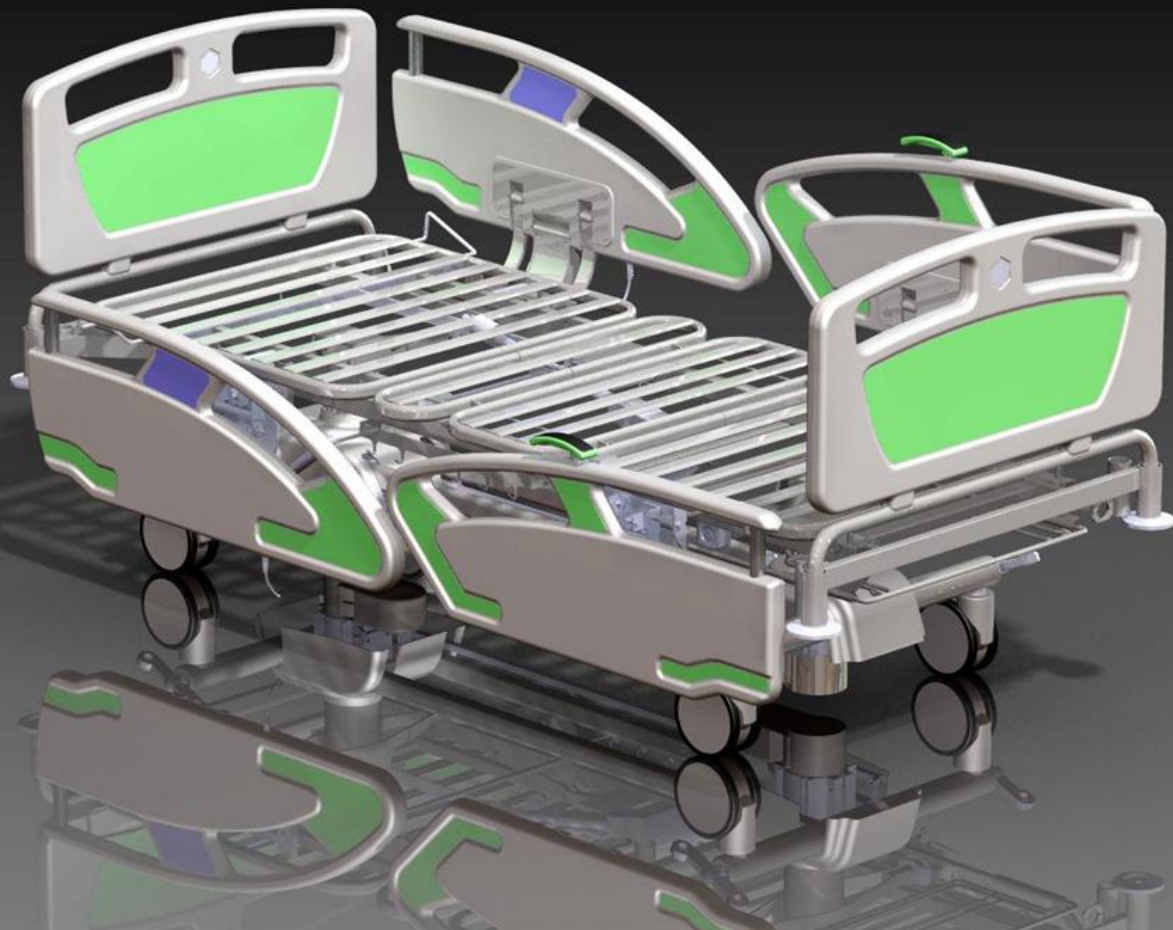

M O N E O
PHARMA GROUP

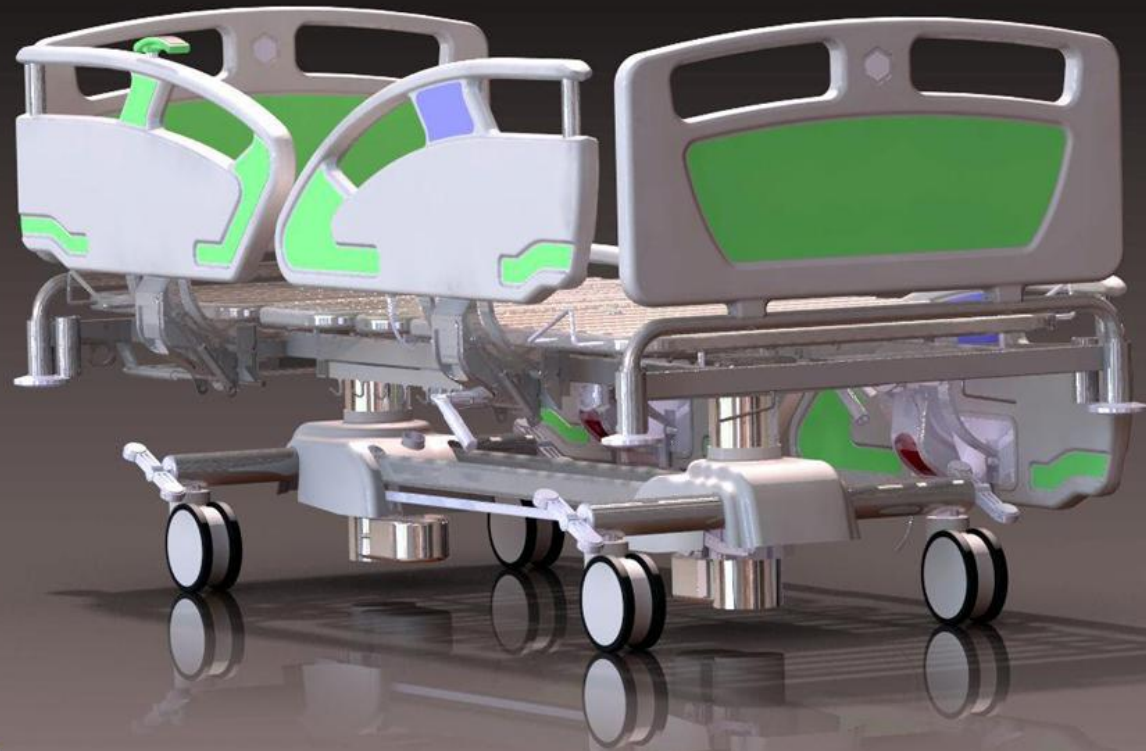

M O N E O
PHARMA GROUP

PROMA
REHA

NEW MODEL
2010
OF THE YEAR



**INTENSIVE
AND STANDARD CARE BED**
TREND 2C



TREND 2C bed in chair position

TECHNICAL SPECIFICATION:

Maximum overall dimensions: 218 x 98 (102) cm
Patient area dimensions: 200 x 85 (90) cm
Suggested mattress dimensions: 200 x 85 (90) cm
Patient area height onto mattress: 45-65 cm
Side rails height over patient area: 42 cm
Bed-head height over patient area: 36 cm
Maximum Trendelenburg tilt: 22°
Maximum Reverse Trendelenburg tilt: 20°
Empty bed weight: 128 kg
Bed loading capacity including mattress and accessories: 240 kg
Horizontal cross-bar loading capacity: 75 kg

Notice:

Please specify dimension 90 x 200 in your order when planning to use a 90 cm wide mattress.

Key features of TREND line beds:

- Easy to clean, disinfectable patient area made of HPL
- Materials in reach of patient are antibacterial (ABS plastic, HPL, powder coated steel, stainless steel)
- Backup battery with automatic charging, diagnostics, indication of capacity and charging indication (optional)
- Alarm for brake-off signalization when plugged in (optional)
- Electric Trendelenburg and reverse Trendelenburg
- Ergonomic nurse control panel with predefined functions and locks of patient controls functions
- Removable plastic bed-heads, easy folding plastic side-rails with integrated patient controls
- Very easy bed manipulation and transportation on wheels of diameter 125 mm with central brake equipped with 2 or 4 levers
- Two integrated horizontal cross-bar and infanation rod holders
- Integrated patient area extension
- Full electric adjustable bed (H / Lo, back and leg part, call part adjusted manually, autoregistration of back part, bumper wheels, CPR for back part)

Optional modifications

- Different types of foot switches (2/4)
- X-ray transparent back part with tilt back part made of steel lamellae
- CPR of back part
- Patient handcontrol switch
- Optional siderail and bed-head type
- Electric ground connector
- Patient area width 85 or 90 cm
- Linon holder
- Wheels of diameter 125/150 mm w/ brake and 2 or 4 levers



TREND 2C bed in Trendelenburg position

PROMA
REHA

Patient controls integrated in side rails (inside and outside) with locks indication and GO button



TREND 2C bed in semi Trendelenburg position

Draw-out folding linen holder



Nurse control panel with preset functions for TREND 2C bed



Manual controlled central brake



TREND 2C bed in high position



TREND 2C bed in low position

Optional bed-head types



YOUR LOCAL PARTNER:

Our Representative Agent & Marketing Arm for Saudi Arabia & Middle East is:



Menaret International Est.
Saudi Office:
P.O. Box: 124530
Jeddah 21342, Saudi Arabia
Tel.: +966 2 6800533
Fax: +966 2 6887001
E-mail: info@menaret.com
www.menaret.com

PROMA
REHA

PROMA REHA, s. r. o.
Riegrova 342
CZ-55203 Česká Skalce
Czech Republic, EU



Tel.: +420 491 11 22 33
Fax: +420 491 54 11 85
sales@promareha.cz
www.promareha.cz



Our sales managers and sales partners will help you to choose the best configuration for your planned use. Please, watch the basic options and optional accessories on pages 56-59 in main catalogue 2010-2011.

AMV
technics

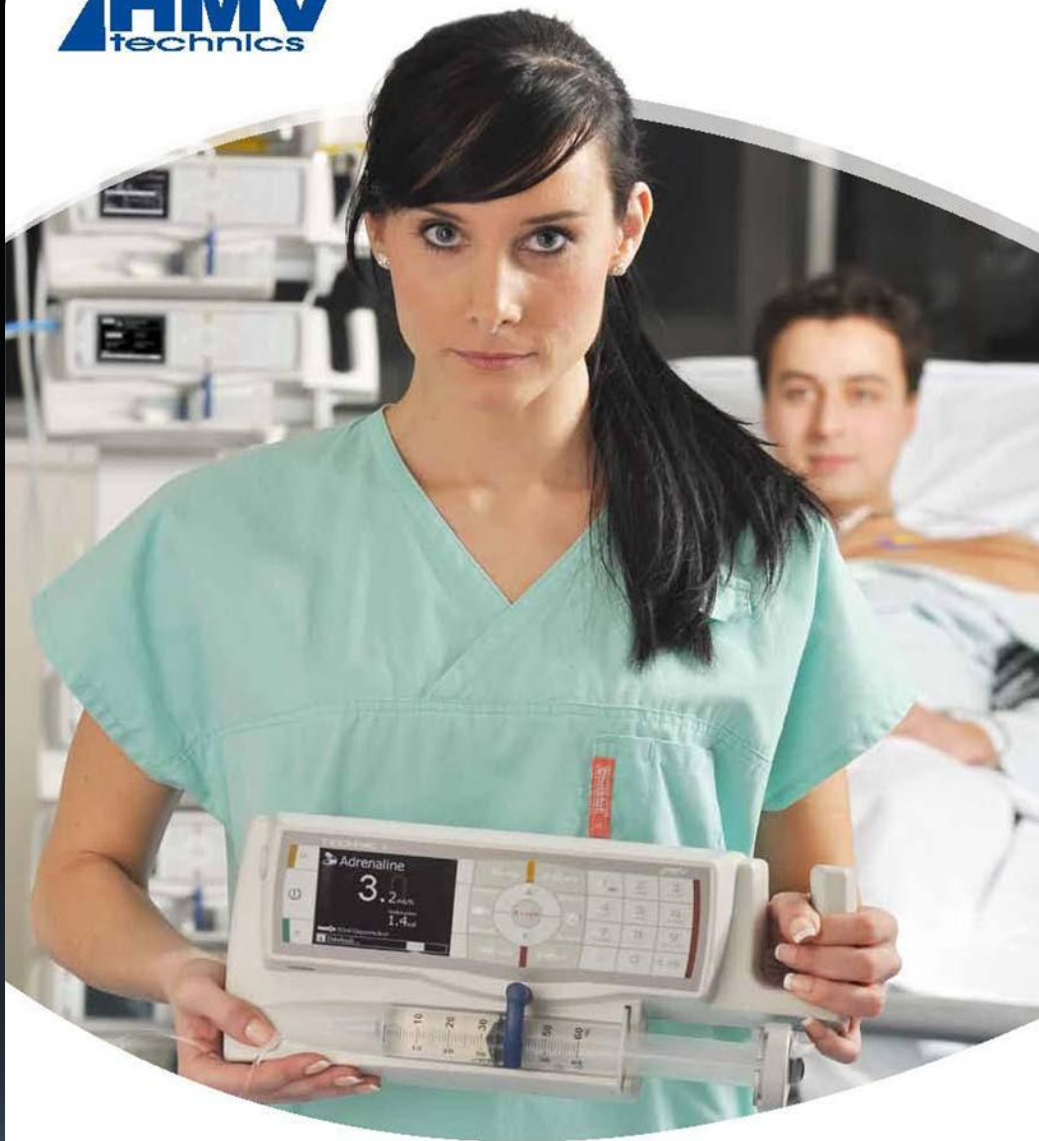

www.amvtechnics.cz

...right choice



M O N E O
PHARMA GROUP

www.amvtechnics.cz

...right choice



M O N E O
P H A R M A G R O U P

BORCAD®

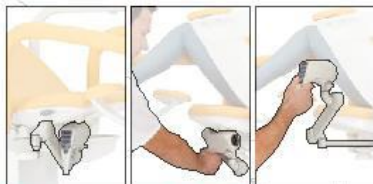

An innovative solution provided by BORCAD - integration of a colposcope in the GRACIE chair reduces spatial demands and increases convenience for the physician during the examination.



LCD monitor allows it connecting to ultrasound.

Instrument trolley saves space in the surgery and provides for the physician's maximum convenience when working.



Mobile wire-less foot controller for comfortable adjustment of an access, examination and ultra-sound position from any place within the doctor's surgery.



Using one of memory functions allows fluent setting up the gynaecological chair GRACIE to a couch for abdominal ultra-sound examination.

www.gracie.eu



Massage segment (contributes to greater comfort and calmness for woman).

Adjusted lumbar support



Easy cleaning



The concept of leg holders enables very quick and unique adjustment of leg holders to required position.



One person and only with one hand can manually adjust this part to several secured working positions and fast slid the footrest under the loading part of bed.



www.borcad.cz/ave

BORCAD[®]



M O N E O
PHARMA GROUP

SICAR



MONEO
PHARMA GROUP

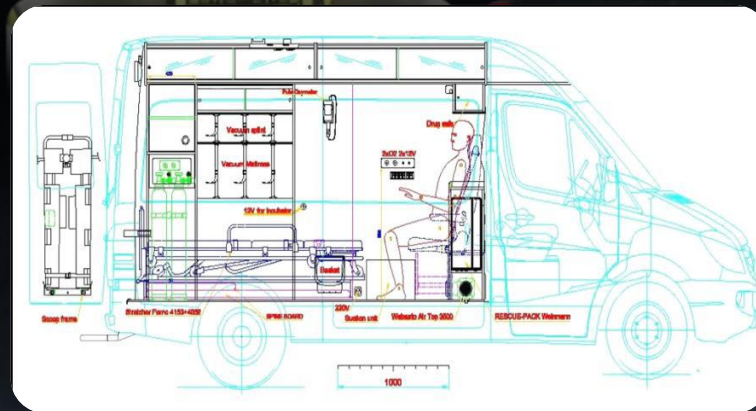

ELAN



M O N E O
PHARMA GROUP



TEKNİK ÖZELLİKLER

- NTCR SD05**
- Sejye yükseklik ayarı trendelenburg hareketleri hidrolik liftler yardımıyla yapılabilmektedir.
 - Eğilendirilebilir sırt kısmı
 - 2 adet metal kilitleme/çözümlenir yan koruyucular
 - Hygienik tasarımı sahip metal malzemeden imal edilmiş başucu ve ayakucu tutamakları
 - 360° dönelenler merkezli ve diğirnal yönde hareketli sağ/sol taraflı veya yerli tekerler (200 mm)
 - Mekanik CPR (sejye sırt kısmının acil durumlarda dışı konuma gelmesi)
 - Plastik koruyucu çarpma tamponları
 - X-Ray ışığı
 - 5 Teker (Sejyenin)
 - Bir aksesuar sepeti
 - linar tutamaç imeli
 - Kemer kancası
 - Aksesuar yordan
 - Yüksekliği ayarlanabilir serum slotları
 - Elektronik yükseklik ayarı
 - 36 d. damla hız ayarı

TECHNICAL SPECIFICATIONS

- NTCR SD05**
- Stretcher height adjustment and trendelenburg movement by the hydraulic lift
 - Inclined backrest
 - 2 pieces metal locked and hidden side rails
 - Hygienic design head and foot arms made from metal material
 - Mechanical CPR (the position of bed backrest for emergency)
 - 360° movable single local & imported castors with linear brake and directional lock for linear direction (200mm)
 - Plastic protection bumpers
 - X-Ray
 - 5 castor
 - 1 basket
 - Urine bag holder
 - Belt hook
 - Accessories slots
 - Height adjustable IV pole
 - Elect
 - 36 d



M O N E O
PHARMA GROUP

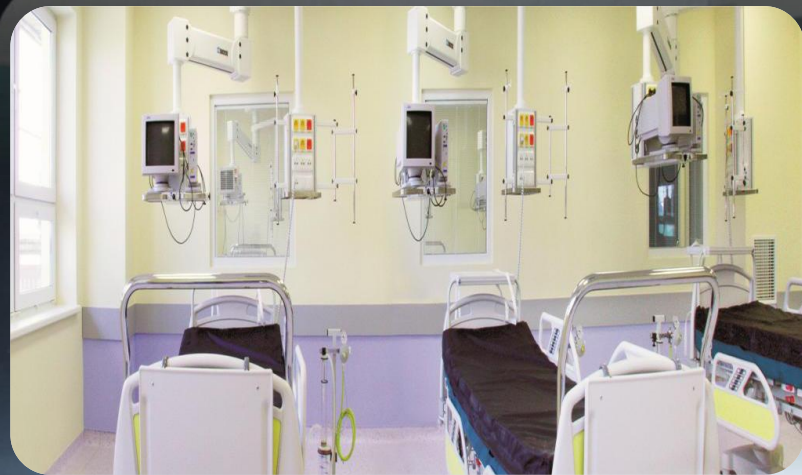



Elan 2C Hospital Bed Full Option



M O N E O
PHARMA GROUP



M O N E O
P H A R M A G R O U P

Type RN07 – DN1

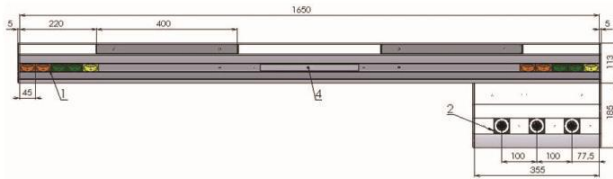

1. Electric socket 230V
2. Medical gas quick outlet
3. Medical rail (payload max. 20 kg and 8 Nm)
4. Direct light cover
5. Indirect and night light cover
6. Indirect light
7. Night light
8. Direct light

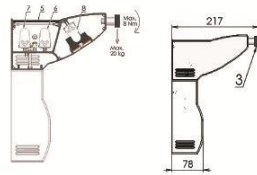

HEAD BED UNIT type RN07 - DN1

Characteristics:

- Material Al profile
- Colour RAL
- Length of the module – 2,000 mm
- Gas outlets standard – BS standard
- Without medical rails



Components of the Head Bed Unit per bed	QTY.
Gas outlet O2	2 pcs
Gas outlet Vac	2 pcs
Electric sockets	4 pcs
Direct light	1 pcs
Indirect light	1 pcs
Provision for nurse call	1 pcs

Type RN07 – DN1



1. Electric socket 230V
2. Medical gas quick outlet
3. Medical rail (payload max. 20 kg and 8 Nm)
4. Direct light cover
5. Indirect and night light cover
6. Indirect light
7. Night light
8. Direct light

Medical gas quick outlets could be placed either on the right side or on the left side of the module.



	Electric sockets	Medical gas quick outlet	Indirect light	Direct light	Night light
RN07-DN1ad	20x	3x	1x	1x	1x



M O N E O
PHARMA GROUP

Pharmakon



M O N E O
P H A R M A G R O U P

MEDIN



M O N E O
PHARMA GROUP

CHEIRON Victoria Suction unit Cheiron





BATIST

DISPOSABLES
OT PRODUCTS



M O N E O
PHARMA GROUP

PRODUCTION LINES

- Wound care
- Bandages
- Hygienic products
- Incontinence products
- Medical tapes and plasters
- Hemostatics
- Surgical drapes gowns and accessories

BATIST

Technology in the service of man



Chirana

- Anaesthesia work stations
- Apparatus for lung ventilation
- Monitors



M O N E O
P H A R M A G R O U P

Anaesthesia work stations of Chirana

Omega



Libera



Chirana



M O N E O
PHARMA GROUP

Anaesthesia work stations of Chirana

Media



Xenon



Chirana



M O N E O
PHARMA GROUP

Anaesthesia work stations of Chirana



Xenon

Libera

Omega

Media



ISO 9001/ISO 13485
CERTIFIED COMPANY



Chirana



M O N E O
PHARMA GROUP

Apparatus for lung ventilation of Chirana

AURA



Chirana Dental



M O N E O
P H A R M A G R O U P

smile
classic



put your trust
in tradition



CHIRANA
Medical STARÁ
TURÁ



M O N E O
PHARMA GROUP

Tradition



Succes of the past quality of the present



Chiradent 654



Smile Elegant



M O N E O
PHARMA GROUP

Charm or Elegant ?

Decision is up to you ...

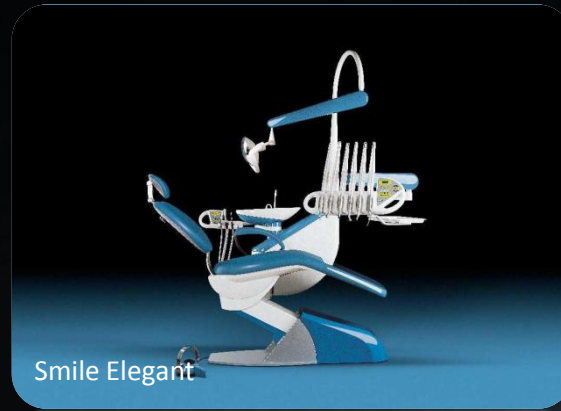

They meet all your desires

- Attractive design
- Comfort for you and your patient
- Optional positioning of instruments
- Electric function of cyclic reversing of micromotor
- Detachable and easy manipulation of upper delivery systems of hoses (CHARM - whips)
- Changing of dentist table position through automatic brake
- Regulation of micromotor speed already from 60 rev/min –
- Indication of necessity of instruments treatment (lubrication)
- Built-in retraction valve
- Complete control of the unit and chair via keyboard on dentist table
- All functions can be independently adjusted for two doctors
- Porcelain swivel spittoon bowl
- Disinfecting system of instruments' water ways
- System of central suction (dry and wet)

Smile Mini for your maxi smile



Smile Mini 02



Smile Mini 02 stationary



Smile Mini 02 SU



Smile Elegant SU



Smile Static



Smile Classic S

Rich offer for every situation ...

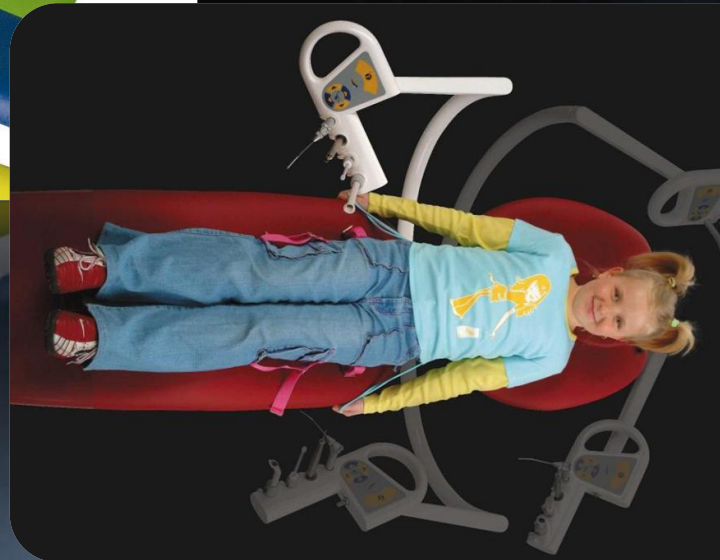

- Design
- Ergonomics
- Hygiene
- Comfort



M O N E O
PHARMA GROUP

Colors

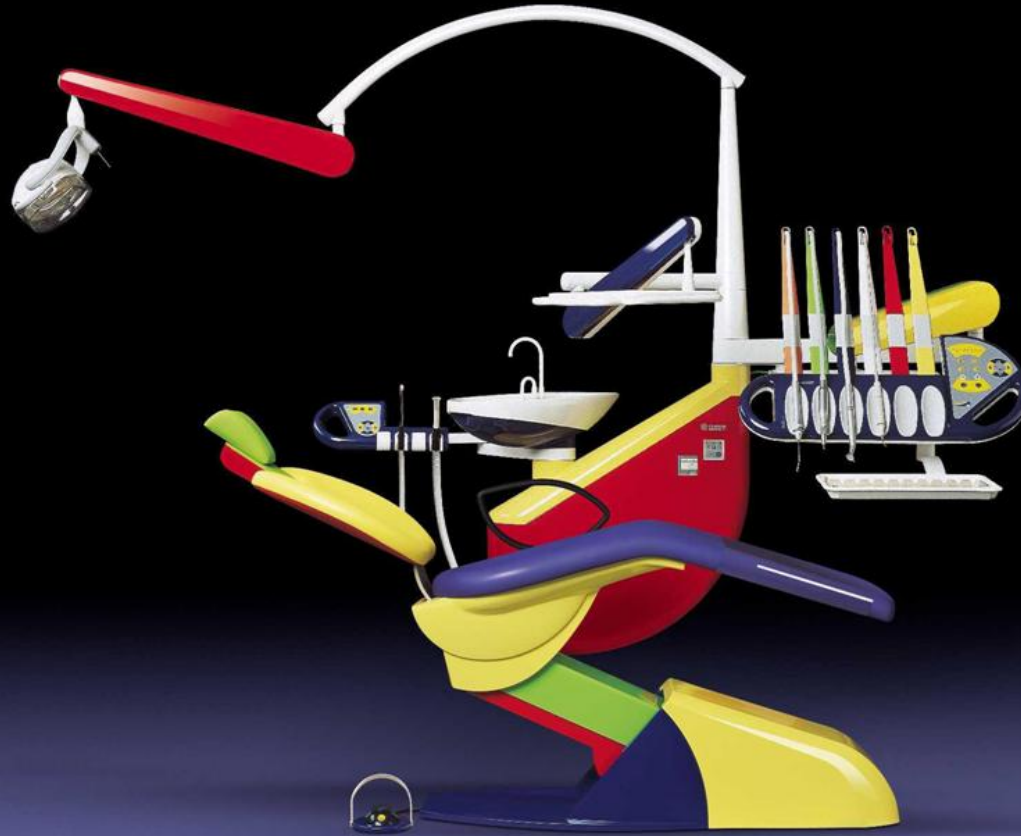

Colors for your life style



M O N E O
PHARMA GROUP

Smile Music for your concert



d e n t á l n e i n s t r u m e n t s
C h i r a n a M u s i c
C h i r a n a M u s i c

168 D-T

NEW

**Contra-angle
120 L**
REF 033 2827 1 00 01
1:1

with light
material: stainless steel
compatible with 168 D-T head
operating speed: max 40 000 min⁻¹
sterilizable in autoclave at up to 135 °C

**Нижняя часть
120 L**
№ для заказа 033 2827 1 00 01
1:1

с подсветкой
поверхность из нержавеющей стали
возможность присоединения головки 168 D-T
рабочие обороты: max 40 000 min⁻¹
стерилизация в автоклаве до 135 °C

Spodný diel
120 L
obj. č. 033 2827 1 00 01
1:1

svetelný
nerezový povrch
možnosť pripojiť hlavíčku 168 D-T
pracovné otáčky: max 40 000 min⁻¹
sterilizácia v autokláve do 135 °C

Ch 660 LIGHT

CHIRANA Medical

p r e V á ť s k o n c e r t
f o r y o u r c o n c e r t

CHIRANA Medical, a.s., Stará Turá, SLOVAKIA
www.chirana.eu MED/2007/06

120 D
Chirana
Slovakia

**Contra-angle
handpiece 120D**

Head 168D/T

110 D
Chirana
Slovakia
x 0202

**Straight
handpiece
110D**

P2ED460-M.05

**Electrical micro-
motor P2ED 460**



M O N E O
PHARMA GROUP

Dental RTGs



M O N E O
PHARMA GROUP

Favea

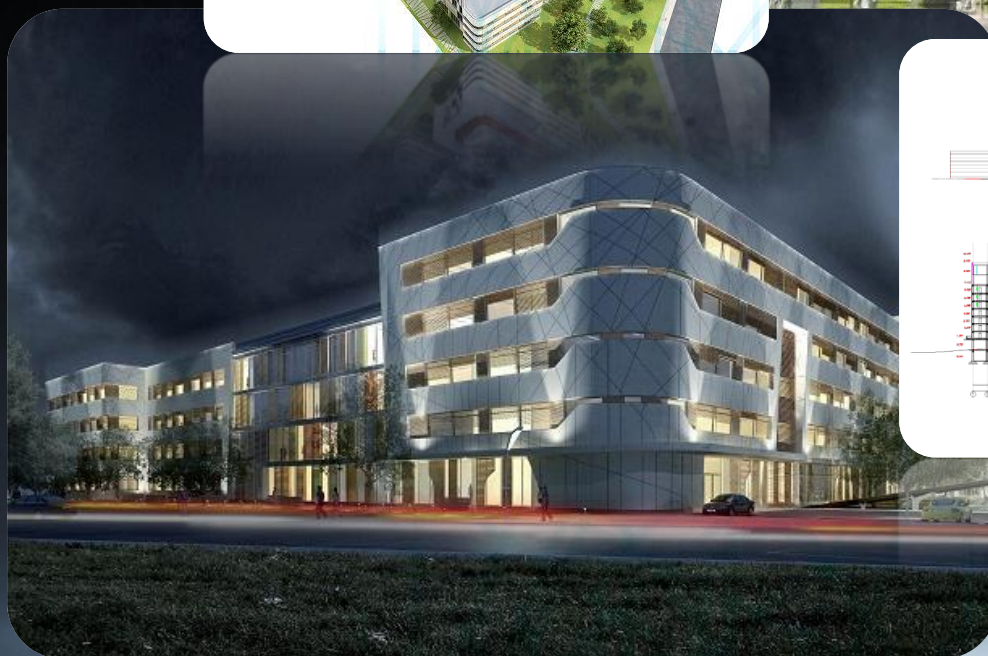
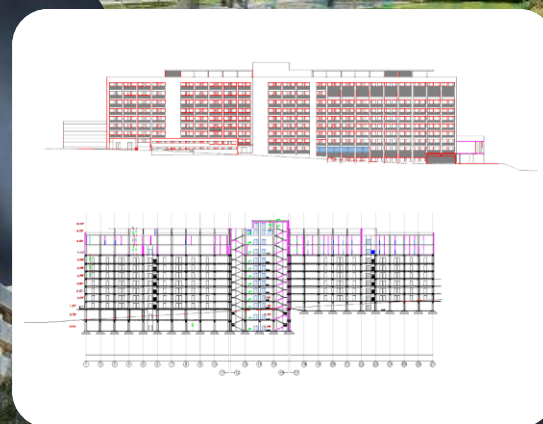

M O N E O
PHARMA GROUP

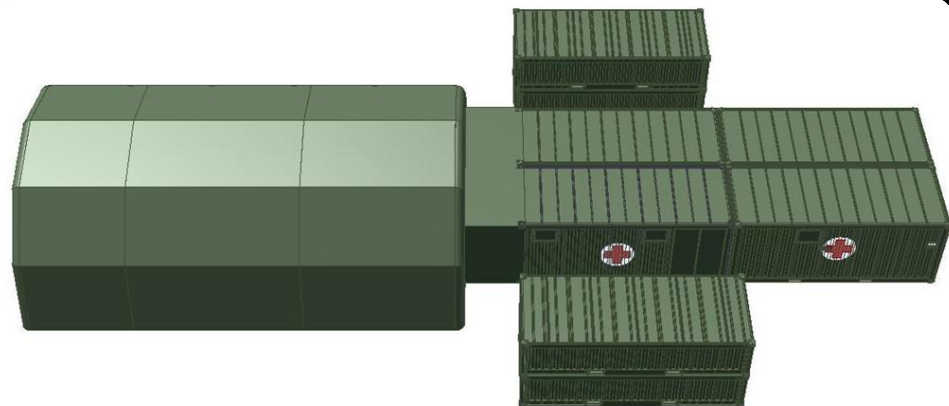





M O N E O
P H A R M A G R O U P

Moneo Pharma Group Sp. z o.o.

01-015 Warsaw, Poland

str. Skwer Ks. Kard. Stefana Wyszyńskiego 5 / 25

tel/fax: 00 48 22 621 67 80

e-mail: biuro@moneopharma.pl